



BOSCH
Invented for life

BOSCH HORN

Catalogue

2019

Driven by **PRESENCE**

The Art of Sound

Introduction

How it all began	2
------------------------	---

Introduction to Product

The Structure	3
The Kinetics	4
The Acoustics	5

Frequently Asked Questions	6
---	---

Product Range Comparison	7
---------------------------------------	---

Product Ranges

Disc Horns	9
Fanfare Horns	17
Compressor Trumpets	24
Backup Buzzer	28

Application Summary	29
----------------------------------	----

Appendix	33
-----------------------	----

How it all began...

The Bosch Buzzer

Automotive horns did not exist till almost a hundred years ago. At that time, in order to signal their own presence and to warn other road users, drivers used anything that made a loud enough noise. Bosch saw in this clamour the need for a device that would be easier on the ears.

In 1913 Bosch filed the first patent worldwide for automotive horns.

In 1919 we developed the buzzer system, which produced a continuous and uniform tone with a single diaphragm. This tone, however, made it difficult for other road users to estimate the direction or proximity of the vehicle. Bosch later introduced a second diaphragm, the 'harmonic diaphragm', which enables other road users to better determine the position of the warning signal.

Later technological advancements led to more warning device technologies and types, such as compressed-air and electro-pneumatic fanfare horns.



Today Bosch horns are original equipment in vehicles made by many renowned vehicle manufacturers. But we're not done yet and continue to innovate to bring the motoring world devices that are of:

Powerful Sound



Effective warning power and harmonious sound for urban and rural roads

High Durability



Patented Teflon filter and corrosion-, impact- and weather-resistance factors enhance endurance and life

Design, Colour & Size



Suitable for internal/external/visible mounting and tight or spacious installation spaces

Broad Application



Available in 6V, 12V and 24V versions

ECE Compliance



Bosch horns are made to ECE standards

Disc Horn

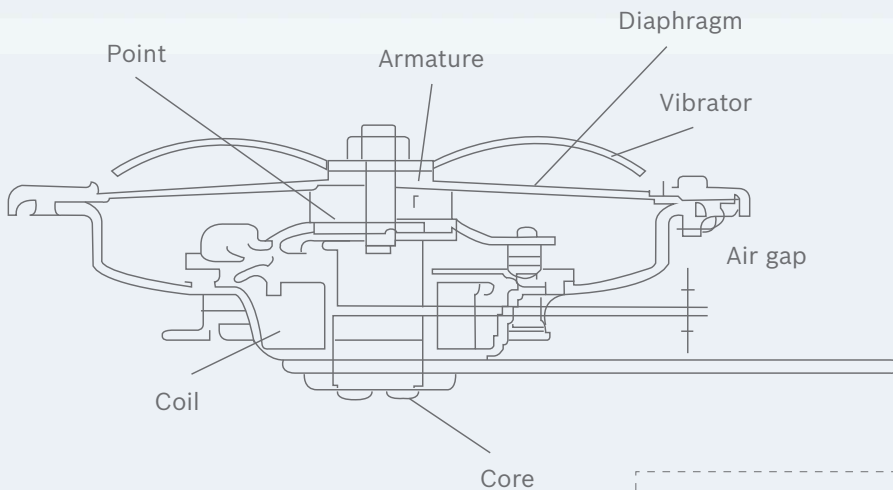

- **Diaphragm**
Thin, flexible metal membrane that creates the sound
- **Armature**
Connected to the diaphragm
- **Solenoid Coil**
To create the driving force
- **Contact Point**
Regulates current flow through the coil
- **Vibrator (in disc horns)**
Moves in a magnetic gap and vibrates to the diaphragm to create sound by resonance
- **Sound Chamber and Trumpet (in fanfare horns)**
Resonates the sound waves along the chamber wall

Fanfare Horn

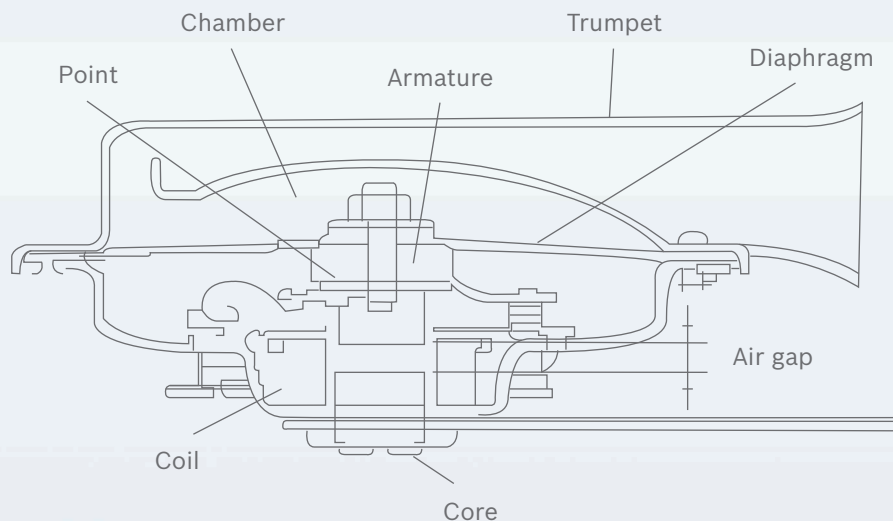

The Kinetics

Harmony in Motion

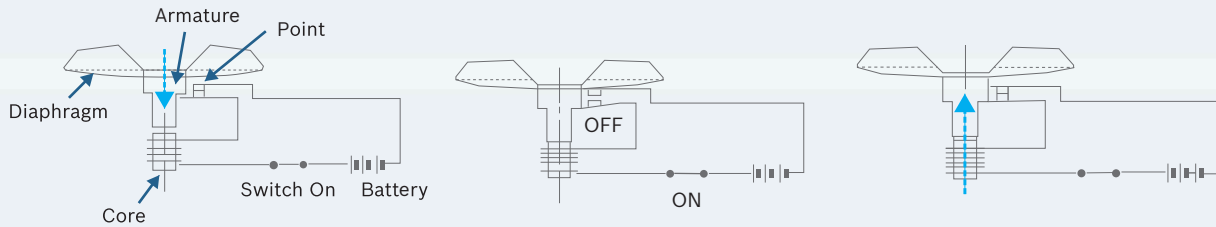



1 When horn is activated, current flows through the coil and forms a magnetic field, drawing the armature to the core.

2 As the diaphragm and armature move towards the core, the contact point disengages and stops the current flow, causing the armature to spring back after striking the core. This motion closes the circuit, thereby triggering the process again.

3 The back and forth movement of the armature and diaphragm forms an even and rapid oscillation. This continuous striking movement produces the loud and sustained sound of the horn.

The Construction of Sound

Stage	Disc Horn	Fanfare Horn	Compressor Trumpet
Sound Generation	<ul style="list-style-type: none"> The armature collides with the core Sound is being generated by impact of repeated metallic collisions 	<ul style="list-style-type: none"> Diaphragm vibrates repeatedly via free oscillation Diaphragm design and trumpet length dictates pitch and timbre of sound 	<ul style="list-style-type: none"> Compressed air generated produces alternating air pressure states Diaphragm oscillation results in an air column in trumpet Movement of air column generates sound
Sound Amplification	<ul style="list-style-type: none"> The vibrator creates sound by resonance Sound is amplified by the tone disc 	<ul style="list-style-type: none"> Trumpet resonates and amplifies the sound 	<ul style="list-style-type: none"> Trumpet resonates and amplifies the sound
Sound Propagation	<ul style="list-style-type: none"> Harsh metallic sound travels in straight line Sound is projected forward 	<ul style="list-style-type: none"> Harmonic and fuller sound propagates in fan-like pattern Sound reach is wider, especially within near radius 	<ul style="list-style-type: none"> Sound propagates in fan-like pattern with high volume strength Wide sound reach 

Frequency

Frequency refers to the number of oscillations made by the diaphragm system per second. This determines whether the tone is deep or high-pitched. Frequency is measured in **hertz (Hz)**; 1Hz corresponds to 1 oscillation per second.

If the oscillations are slow, frequency is low and a deep tone results. If the oscillations are rapid, frequency is high and a high tone is produced.

Short wavelength
means lots of waves;
high frequency,
high-sound

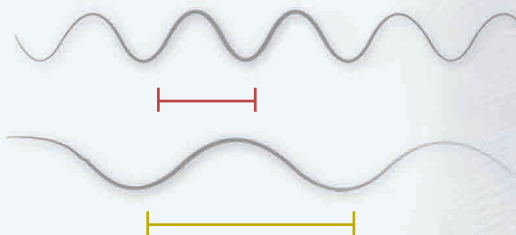

Long wavelength
means fewer waves;
low frequency,
low sound

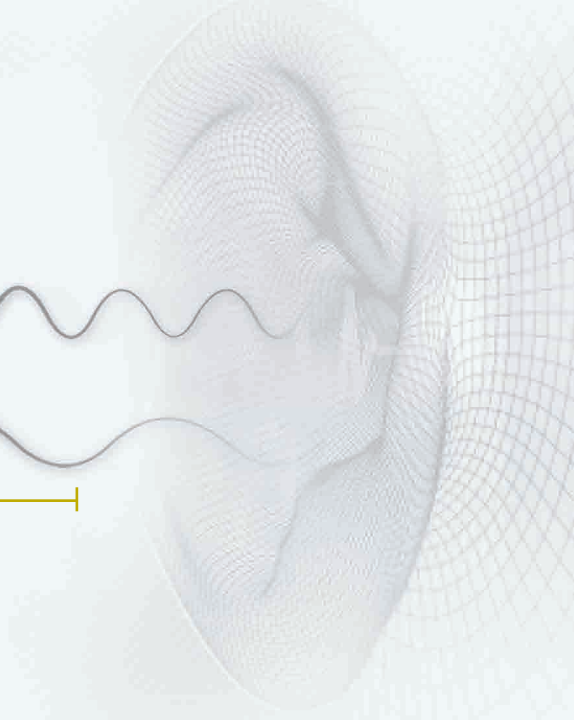

Bosch offers a variety of tone and frequencies to suit your needs and preferences.

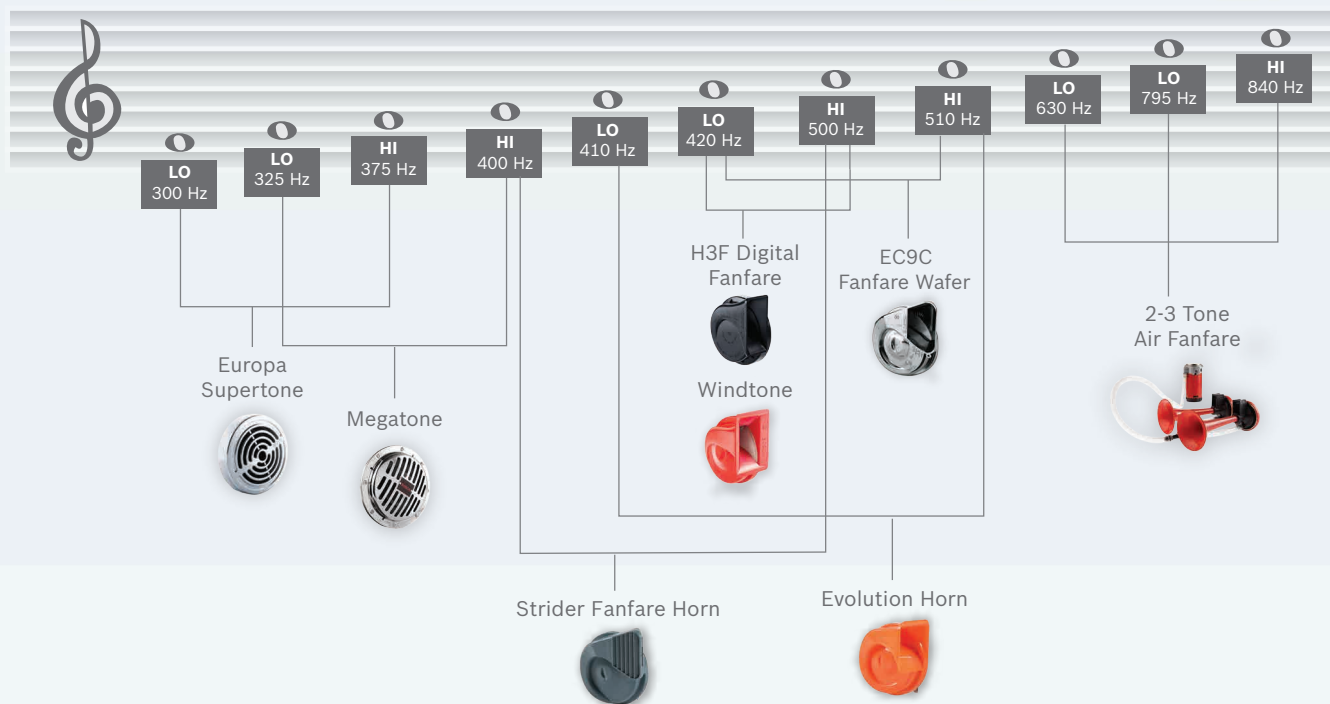

Sound Pressure/Volume

Sound pressure and volume is measured in **decibels (dB)**. This relates to how far and fast the oscillating diaphragm system is being deflected during horn activation.

The distance at which a sound can be heard depends on the direction of the sound wave, the power, and the volume.

ECE standards call for all audible warning devices to have a sound pressure of between 105 and 118 dB. All Bosch horns have a sound pressure within this range.

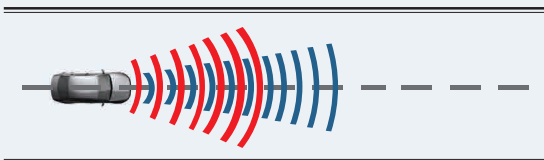

Sound-Wave Propagation of a set of horns with 2 frequencies

Why do Bosch horn products typically come in a set of two horns?

A Bosch horn set comprises a high-tone and a low-tone horn.

A high-tone horn produces a more piercing sound. This enables the signal to reach forward and farther. The low tone with a lower frequency is better heard at close range.

Used together, the two horns **maximise signal area coverage**, thus ensuring better safety.

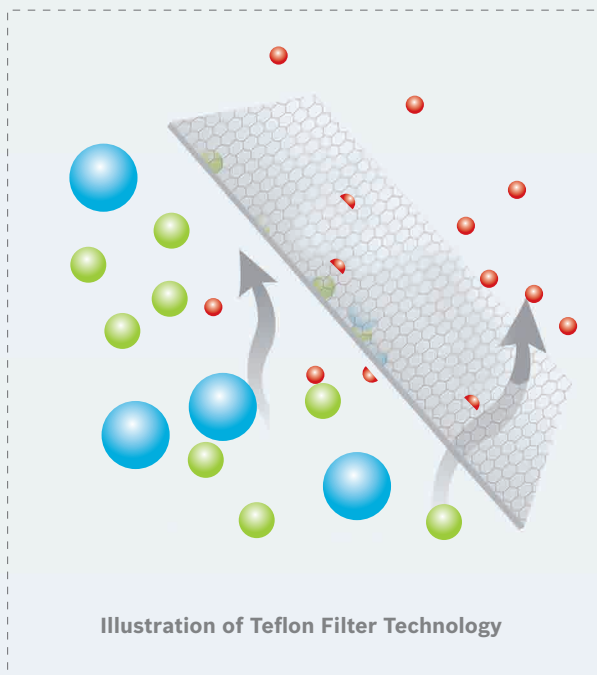

Illustration of Teflon Filter Technology

Small air particles

Water, dust & other large particles

How does Teflon Filter technology work?

The microporous Teflon filter serves two purposes:

- **Pressure compensation:** Allows air to pass through for ventilation and to relieve the pressure buildup between the device interior and the atmosphere
- **Keeps out dirt and humidity:** The pores of the filter are designed to allow air through whilst repelling larger particles such as dirt and water

What is the benefit of having corrosion resistance?

Corrosion resistance minimises the effects of wear and tear from exposure to the environment, thereby maximising the horn's performance and service life.

Bosch builds corrosion resistance into its horns by using:

- Special filter technologies such as the patented **Teflon Filter Technology** and **Membrane Filter Technology**
- Passivation and other finishing techniques

Why the need for EMC protection?

Electromagnetic interference occurs when multiple electronic devices within the same electrical system interact together.

EMC protection (Electro-Magnetic Compatibility) minimises the amount of electronic disturbance and interference to other electronic components in the car, such as the ECU, in-car entertainment system, navigation system, etc.

Product Range Comparison

2-Wheeler

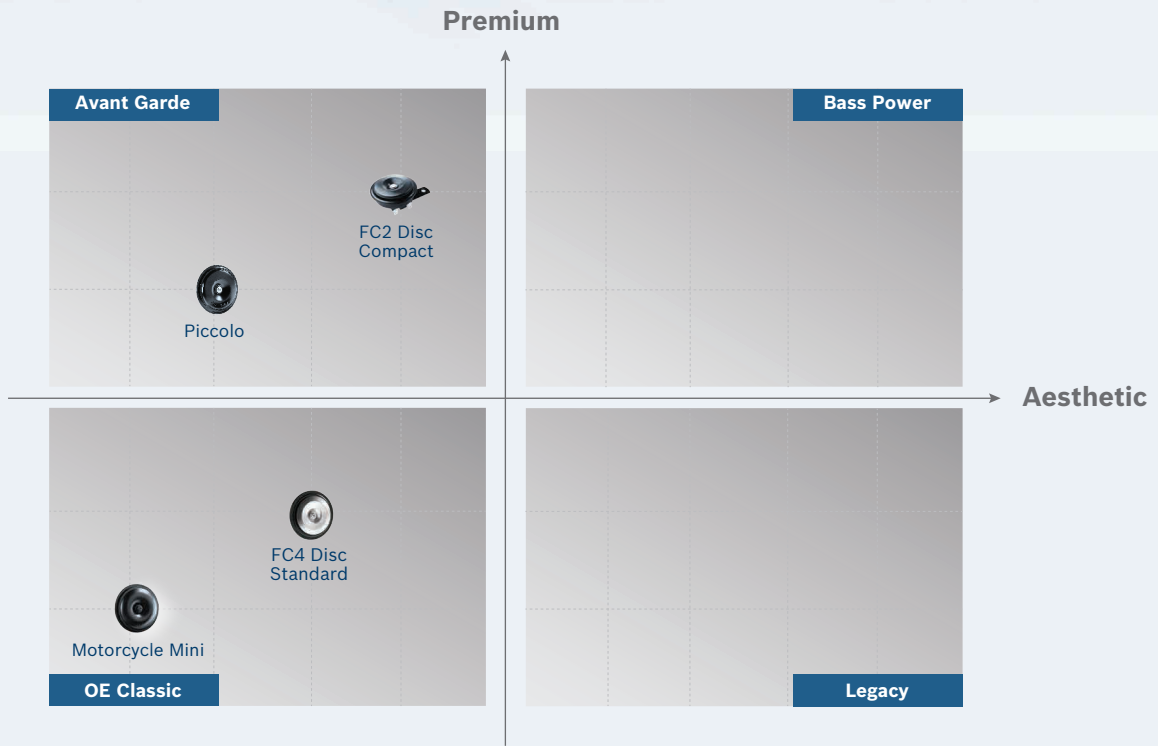

Passenger Car & Light Commercial Vehicles

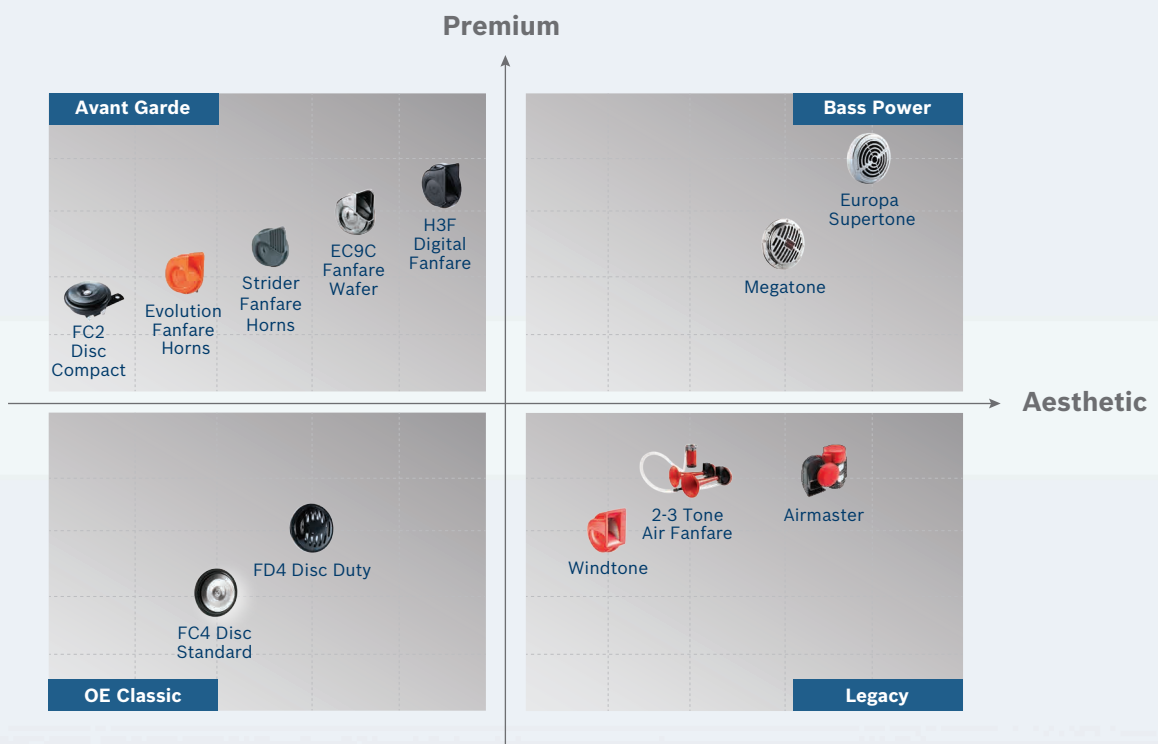

* Product shown is not the actual size.

Heavy Commercial Vehicles

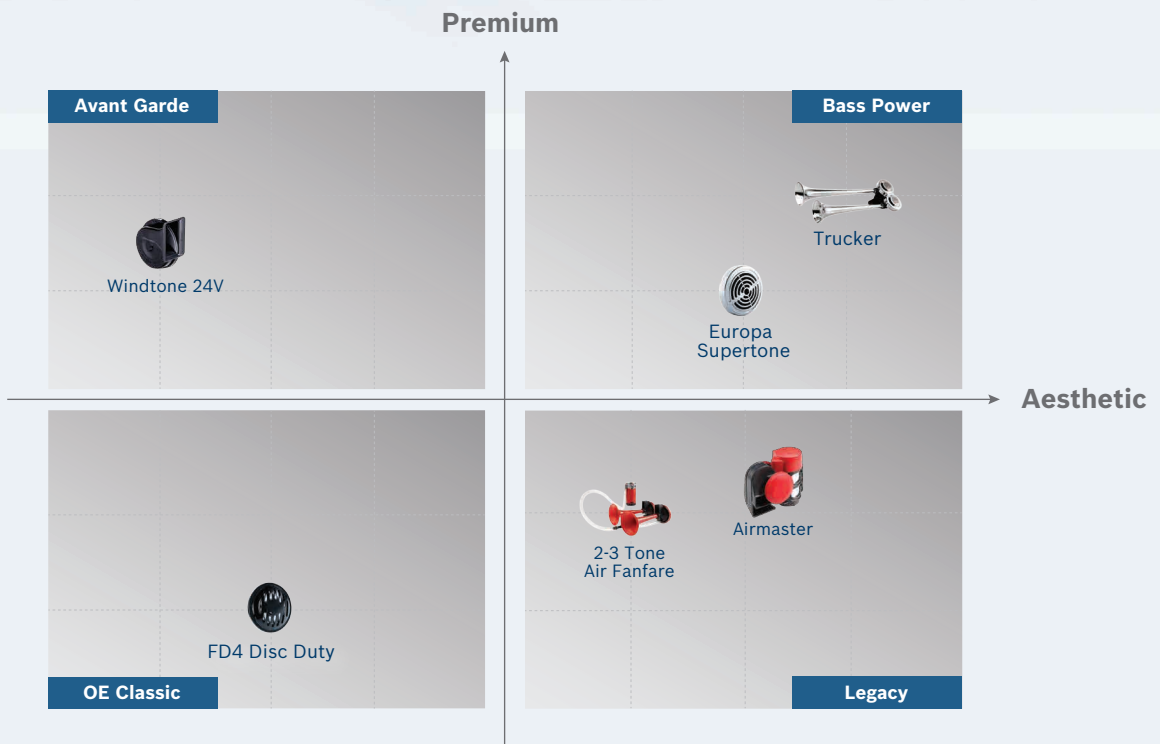

Product Characteristics

Models		DISC HORNS						FANFARE HORNS					COMPRESSOR TRUMPETS		
		Europa Supertone	Piccolo	Megatone	FC2 Disc Compact	Motorcycle Mini	FC4 Disc Standard	FD4 Disc Duty	H3F Digital Fanfare	EC9C Fanafare Wafer	Evolution Fanfare Horn	Strider Fanfare Horn	Windtone	Trucker	2-3 Tone Air Fanfare
RESISTANCE FACTORS	Weather-Resistant	✓		✓	✓		✓	✓	IP54*	IP54*	IP54*	IP56*			✓
	Impact-Resistant	✓		✓			✓	✓		✓			✓	✓	✓
	Corrosion-Resistant	✓	✓	✓	✓	✓	✓	✓	✓	✓	✓	✓	✓	✓	✓
	EMC protection	✓					✓	✓	✓	✓	✓	✓	✓		
	Teflon Filter	✓		✓	✓		✓			✓					
DESIGN & TUNING FACTORS	Compact Design		✓		✓				89mm	93mm	80mm +/- 1	80mm +/- 1			✓*
	Serviceable					✓									
	Extra-high Durability		✓						✓			✓			
	Privileged Vehicles	✓													✓
	Suitable for external mounting	✓		✓				✓	✓					✓	

* Mini option available

** Refer to product page for more details

*IP54 Protected from limited dust ingress, protected from water spray from any direction, limited ingress protection

*IP56 Protected from limited dust ingress, protected from high pressure water jets from any direction, limited ingress protection

fights above weight class



Disc Horns

Produces a metallic "beep" sound with high sound pressure level and far-reaching penetrating power

Europa Supertone

Premium Euro-Style Solution



- For privileged vehicles or other special uses
- Low bassy supertone for use with wide range of vehicle types
- *Suitable for privileged vehicles or other special uses
- Micro-porous Teflon Filter for pressure compensation
- Weather-, impact- and corrosion-resistant
- With EMC protection

Check with your dealer for more information.

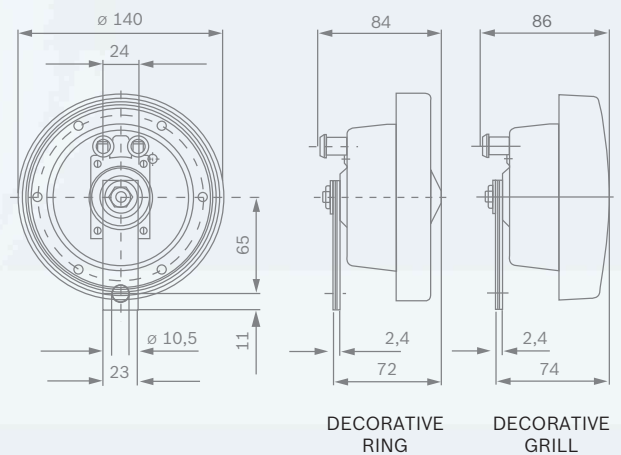

OUR RECOMMENDATION	Design Options						VEHICLE APPLICATION
	Decorative Ring	Black	12V	Set; 2 horns comprising of 1 high tone & 1 low tone	• 300 Hz / 375 Hz	0 986 AH0 210	
	Silver	12V 24V	• 300 Hz / 375 Hz		0 320 223 911		
			• 300 Hz / 375 Hz		0 986 AH0 211		
Decorative Grill	Black	12V	Set; 2 horns comprising of 1 high tone & 1 low tone	• 300 Hz / 375 Hz	0 320 223 910		
	Chrome	24V 24V		• 300 Hz / 375 Hz	0 986 AH0 213		
				• 300 Hz / 375 Hz	0 986 AH0 212		

* High-frequency options available – 375 Hz / 500 Hz
For privileged vehicles or other special uses

For more options and available part numbers, please refer to the Appendix

Piccolo

Your Enduring
Travel Companion

- High-grade copper wire material for better electromagnetic power
- High-strength nylon shell provides improved performance stability
- High durability with enhanced life service
- Corrosion-resistant

Check with your dealer for more information.

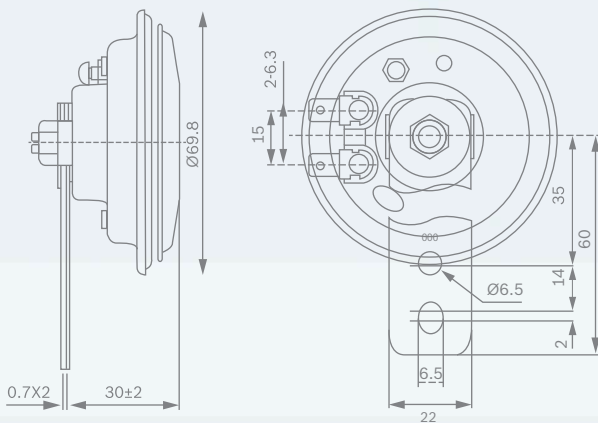

OUR RECOMMENDATION						VEHICLE APPLICATION
	Black	6V 12V	Single Horn	• 420 Hz • 420 Hz	0 986 AHO 713 0 986 AHO 712	

For more options and available part numbers, please refer to the Appendix

Megatone

Announcer with
Powerful Bass Tone



- Supertone horn with large diaphragm for dynamic sound power and signal range
- Chromium-plated protective grill for impact resistance
- Corrosion-resistant
- Suitable for external mounting and off-road applications

Check with your dealer for more information.

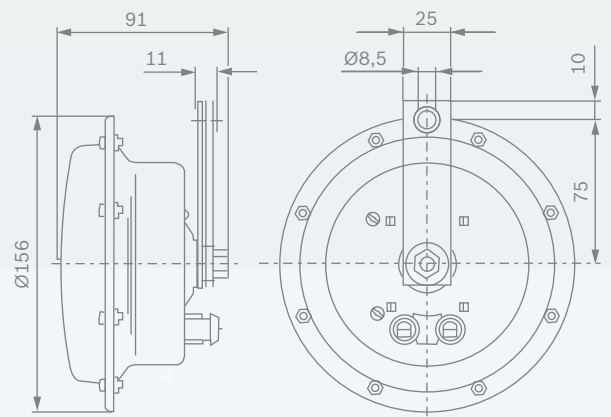

OUR RECOMMENDATION						VEHICLE APPLICATION
	Silver	12V	Set; 2 horns comprising of 1 high tone & 1 low tone	• 325 Hz / 400 Hz	0 986 AH0 203	

For more options and available part numbers, please refer to the Appendix

FC2 Disc Compact

Full Function in Compact Package



- Small and compact
- Easy installation in tight spaces
- Dirt- and humidity-resistant with Membrane Filter Technology
- Corrosion-resistant

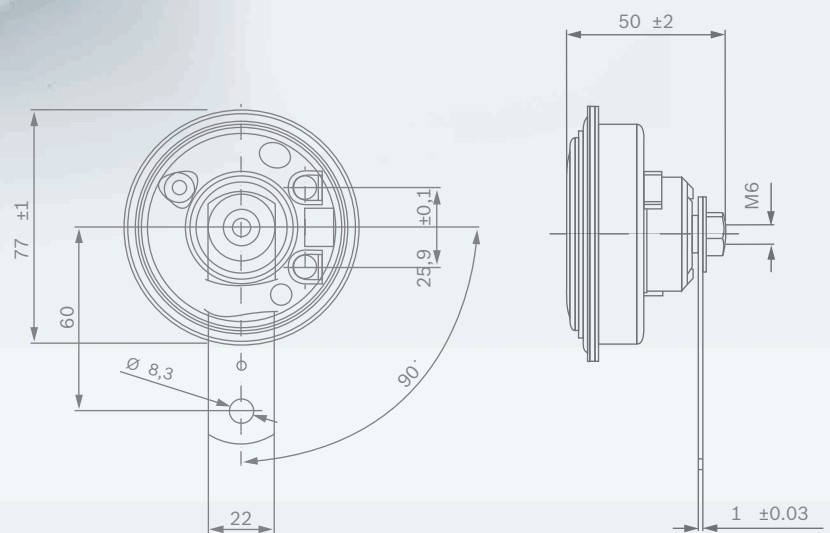

Check with your dealer for more information.

OUR RECOMMENDATION						VEHICLE APPLICATION
	Black	12V	Set; 2 horns comprising of 1 high tone & 1 low tone	• 350 Hz / 420 Hz	0 986 AH0 103	

For more options and available part numbers, please refer to the Appendix

Motorcycle Mini

Easy Rider



- Includes a serviceable component
- Can be adjusted and tuned to achieve desired tone output
- Corrosion-resistant

Check with your dealer for more information.

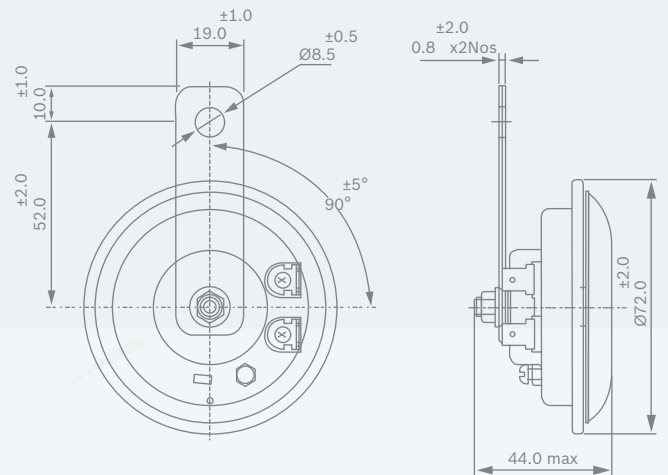

OUR RECOMMENDATION						VEHICLE APPLICATION
	Black	6V	Single Horn	• 430 Hz	0 986 AHO 002	
		12V		• 430 Hz	0 986 AHO 003	

For more options and available part numbers, please refer to the Appendix

FC4 Disc Standard

The All-Weather
Disc Horn

- Solid mechanical construction for greater durability
- Wide range of mounting & angle options
- Micro-porous Teflon filter for pressure compensation
- Weather, impact and corrosion resistant
- With EMC protection

Check with your dealer for more information.

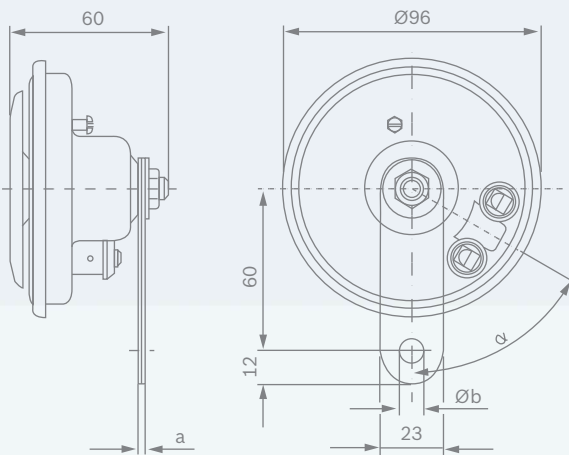

OUR RECOMMENDATION	Design Options						VEHICLE APPLICATION
	Standard (Single Point Mounting)	Steel	6V 12V	(6V) Single Horn (12V) Set; 2 horns comprising of 1 high tone & 1 low tone	<ul style="list-style-type: none"> • 335 Hz • 335 Hz / 420 Hz 	<ul style="list-style-type: none"> 0 986 320 101 0 986 320 191 	
	Black	6V 12V		<ul style="list-style-type: none"> • 335 Hz • 335 Hz / 420 Hz 	<ul style="list-style-type: none"> 0 986 320 102 0 986 AH0 192 		
	3-Point Mounting	Black	12V	Single horn with 3-point type connection for mounting	<ul style="list-style-type: none"> • 335 Hz 	0 986 320 110	

For more options and available part numbers, please refer to the Appendix

FD4 Disc Duty

All-Round
Commerical Use



- Solid mechanical construction for greater durability
- Weather- and impact-resistant
- Corrosion-resistant
- With EMC protection
- Suitable for external mounting and off-road applications

Check with your dealer for more information.

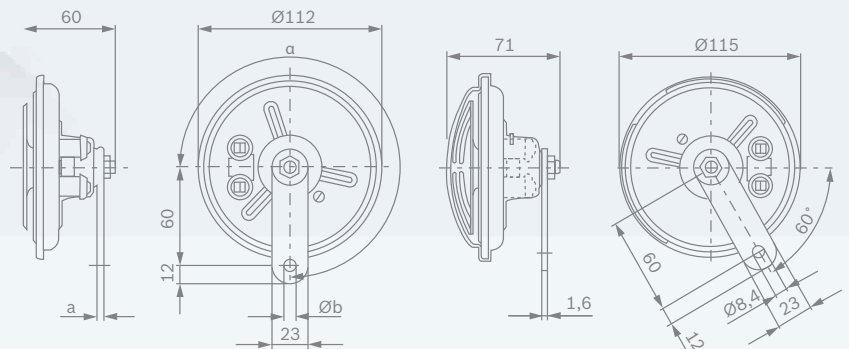

STANDARD

DECORATIVE GRILL

OUR RECOMMENDATION	Design Options						VEHICLE APPLICATION
	Standard	Steel + Grey	12V 24V	Set; 2 horns comprising of 1 high tone & 1 low tone	• 335 Hz / 420 Hz • 335 Hz / 420 Hz	0 986 320 392 0 986 320 394	
	Black	24V		• 335 Hz / 420 Hz	0 986 AH0 193		
Decorative Grill	Steel+ Black Grill	12V	Set; 2 horns comprising of 1 high tone & 1 low tone	• 335 Hz / 420 Hz	0 986 320 393		

For more options and available part numbers, please refer to the Appendix

mellowed brilliance



Fanfare Horns

Produces a soft timbre and mellow sound for a more harmonic experience. Larger fanfares give full-bodied and more robust harmonics with a wider sound spectrum.

H3F Digital Fanfare

The Power of Digital

- Microchip technology for enhanced sound quality and low sound sensitivity
- Up to 10 times longer service life
- Stable sound properties even with long continuous honking
- Resistant to environmental fluctuations
- Corrosion-resistant with Nano-Filter technology
- With EMC protection

Check with your dealer for more information.

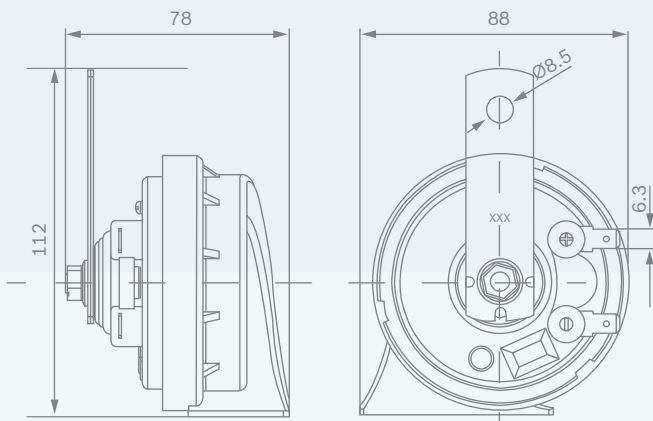

OUR RECOMMENDATION						VEHICLE APPLICATION		
	Black	12V	Set; 2 horns comprising of 1 high tone & 1 low tone	• 420 Hz / 500 Hz	0 986 AHO 601			

For more options and available part numbers, please refer to the Appendix

EC9C Fanfare Wafer







The Ultrathin
Travel Mate

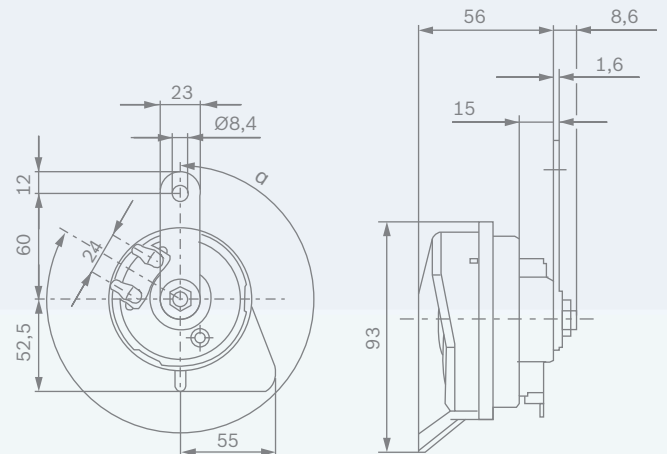

- Ultra-thin, ultra-lightweight electro-pneumatic fanfare
- Vertical mounting for forward sound propagation and reduced water-pooling
- Micro-porous Teflon filter for pressure compensation
- Impact- and corrosion-resistant
- With EMC protection

Check with your dealer for more information.



OUR RECOMMENDATION						VEHICLE APPLICATION
	Chrome	12V	Set; 2 horns comprising of 1 high tone & 1 low tone	• 420 Hz / 510 Hz	6 033 FB1 510	
Black	12V		• 420 Hz / 510 Hz	9 320 335 206		

For more options and available part numbers, please refer to the Appendix

Evolution Fanfare Horn

The Compact
Broadcaster

- **Most compact**, easy installation in limited spaces
- Wide-angle sound coverage
- Resistant to corrosion, dirt, humidity

Check with your dealer for more information.

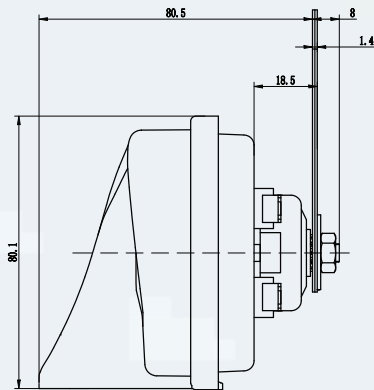
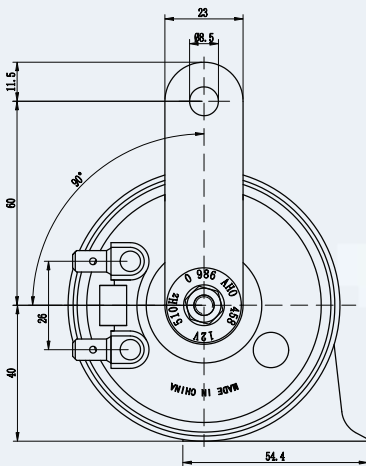

OUR RECOMMENDATION						VEHICLE APPLICATION	
	Orange	12V	Single (Low Tone)	• 410 Hz	0 986 AH0 457		
			Single (High Tone)	• 510 Hz	0 986 AH0 458		
			Set (Low & High Tone)	• 410 Hz / 510 Hz	0 986 AH0 459		

For more options and available part numbers, please refer to the Appendix

Strider Fanfare Horn

The All-Weather Fanfare Horn

Rugged design and materials ensure long service life and protection against weather elements

- Low power consumption for reliable performance even under sub-optimal battery conditions
- Loud, harmonious tone ensures clear communication to other road users

Check with your dealer for more information.

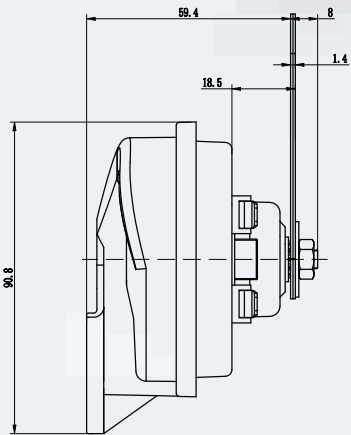
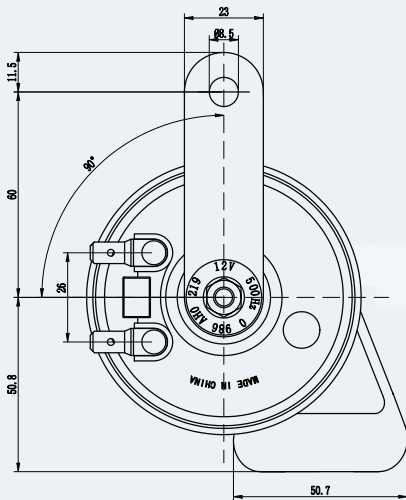

OUR RECOMMENDATION						VEHICLE APPLICATION	
	Grey	12V	Single (Low Tone)	• 400 Hz	0 986 AH0 218		
			Single (High Tone)	• 500 Hz	0 986 AH0 219		
			Set (Low & High Tone)	• 400 Hz / 500 Hz	0 986 AH0 220		

For more options and available part numbers, please refer to the Appendix

Windtone

The All-Round Fanfare

- Economical fanfare option
- Large trumpet for enhanced sound propagation
- Corrosion-resistant
- With EMC protection

Check with your dealer for more information.

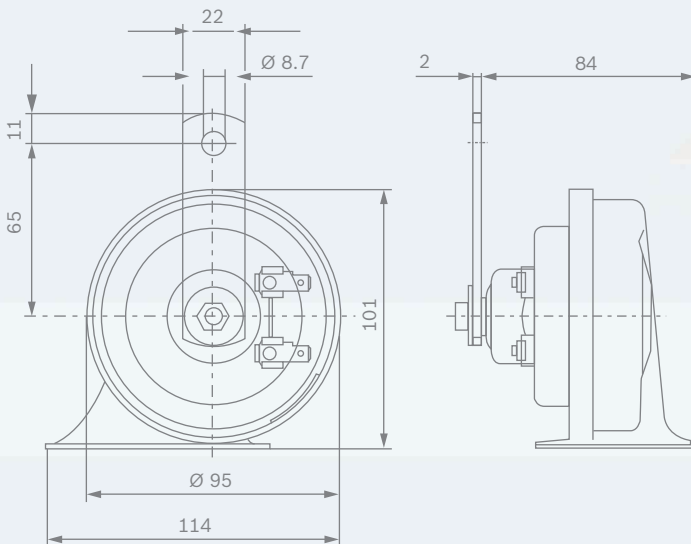

OUR RECOMMENDATION						VEHICLE APPLICATION	
	Red	12V	Set; 2 horns comprising of 1 high tone & 1 low tone	• 420 Hz / 500 Hz	0 986 AH0 507		
	Black	12V		• 420 Hz / 500 Hz	0 986 AH0 503		

For more options and available part numbers, please refer to the Appendix

Windtone 24V

Fanfare for the Commercial Vehicle



- Economical fanfare option
- Large trumpet for enhanced sound propagation
- Anti-corrosion protection
- Electrophoretic processing coating
- Suitable for light duty vehicle, buses and trucks

Check with your dealer for more information.

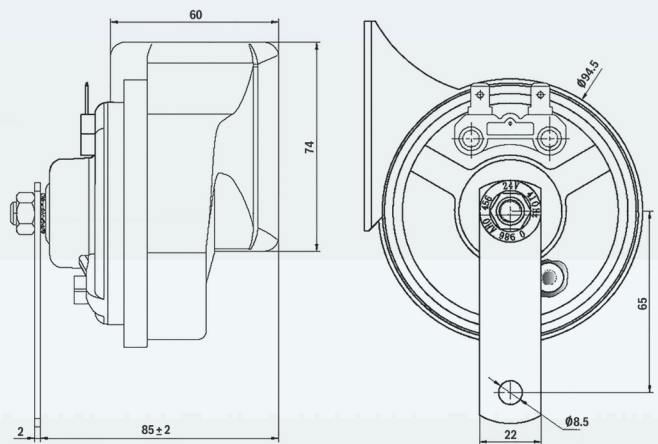

OUR RECOMMENDATION						
	Black	24V	Sets of 2 horns, 1 High tone, 1 Low tone	• 410 Hz / 510 Hz	0 986 AH0 454	

For more options and available part numbers, please refer to the Appendix

goes far & wide



Compressor Trumpets

Generates high-volume output that produces a penetrating signal with wide sound reach

Air Master

Compact and Powerful Air Horn

- For privileged vehicles or other special uses
- Ideal for large trucks and HCVs with built in compressor
- Perfect balance of air compressor system projecting loud and powerful sound
- Harmonic two-toned sound with loud propagation
- Compact and easy installation

Check with your dealer for more information.

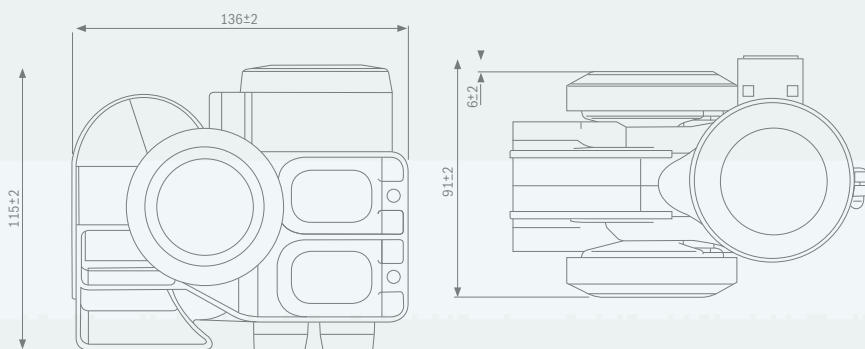

OUR RECOMMENDATION					VEHICLE APPLICATION
	Black with Red	12V	Single horn with 2 trumpet of high and low tone	• 520 Hz/ 660 Hz	
	24V	• 520 Hz/ 660 Hz		0 986 320 401	

For more options and available part numbers, please refer to Appendix

Trucker

The Classic Choice
for Trucks

- Ideal for large trucks and HCVs with built-in compressed-air system
- Penetrating two-tone signal with wide sound reach
- Secure installation with fixed anchorage
- Impact- and corrosion-resistant
- Suitable for external mounting

Check with your dealer for more information.

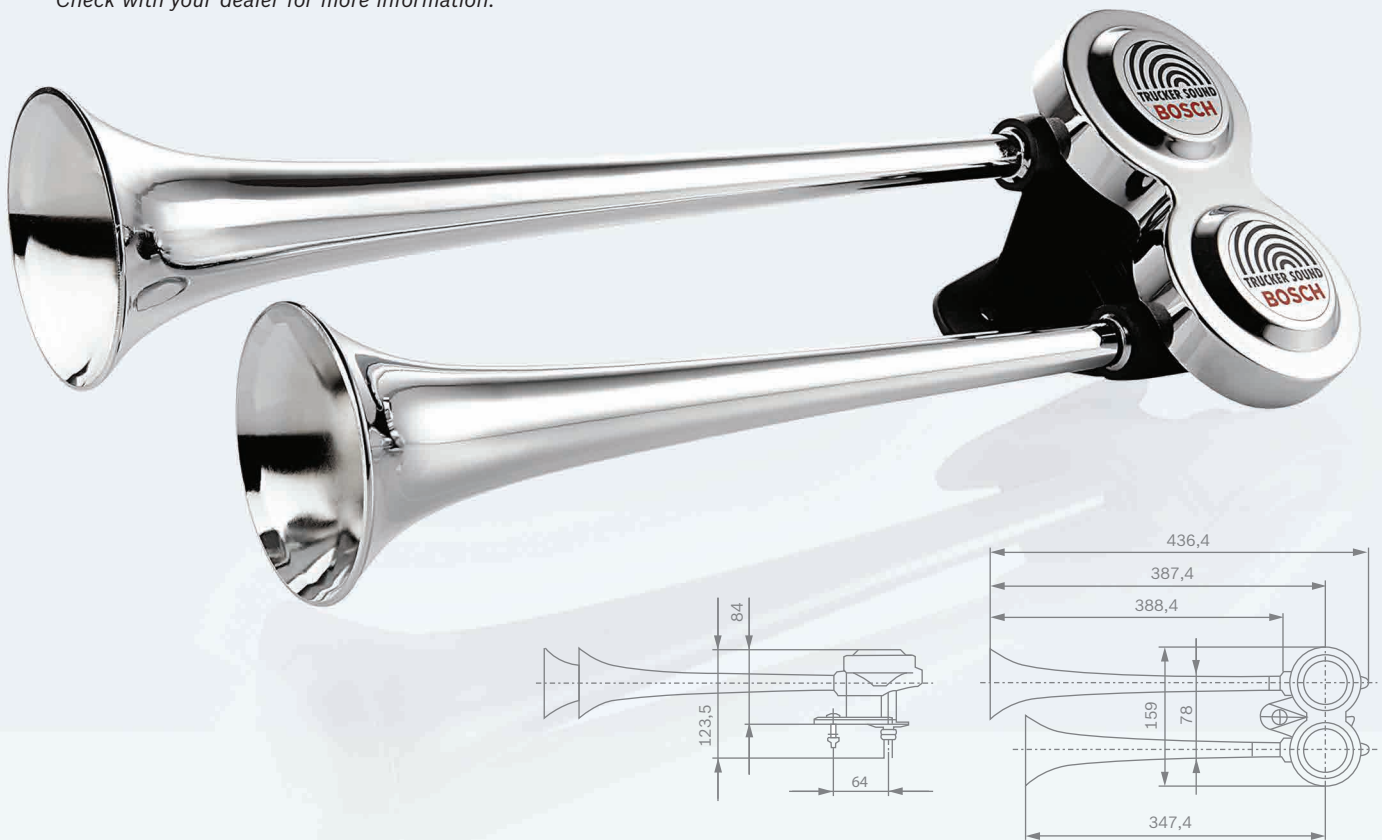

OUR RECOMMENDATION						VEHICLE APPLICATION	
	Chrome	5 - 8 bar	Single horn with 2 trumpets of varying tones	• 300 Hz / 320 Hz	0 328 100 002		

ACCESSORY	Foot Valve	To be fitted on floor of driver's cabin; operated by foot pressure	1 327 011 003
	Protective Cap	Protects connections against dirt and moisture for better weather resistance	3 340 552 025

For more options and available part numbers, please refer to the Appendix

2-3 Tone Air Fanfare

Announce
Your Presence



- Compressor fanfare with fast response time
- High frequency with large capacity and wide sound propagation
- Easy installation with two-hole mounting and blade terminal
- Weather- and impact-resistant
- Compressor unit inclusive

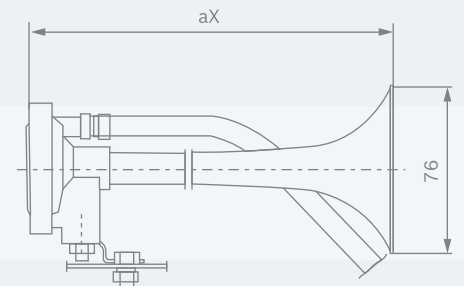
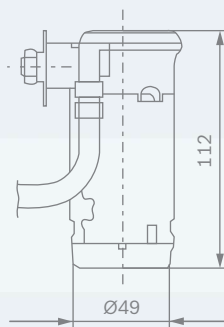

Check with your dealer for more information.

OUR RECOMMENDATION	Design Options						VEHICLE APPLICATION	
	Mini 2-tone	Red	12V	2 trumpets with varying tones, and a compressor unit	• 735 Hz / 785 Hz	0 986 320 003		
	2-tone	Red	12V 24V		• 630 Hz / 795 Hz • 630 Hz / 795 Hz	0 328 003 024 0 328 006 002		
	3-tone	Red	12V	3 trumpets with varying tones, and a compressor unit	• 630 Hz / 795 Hz /840 Hz	0 328 003 025		

For more options and available part numbers, please refer to Appendix

Backup Buzzer

Universal Backup
Beeper Warning Alarm

- Activated as soon as the reverse gear is engaged
- Comes in 2 options: Fixed sound pressure level and self adjusting
- Suitable for commercial vehicles, construction vehicles, cranes and fork lift truck

Check with your dealer for more information.

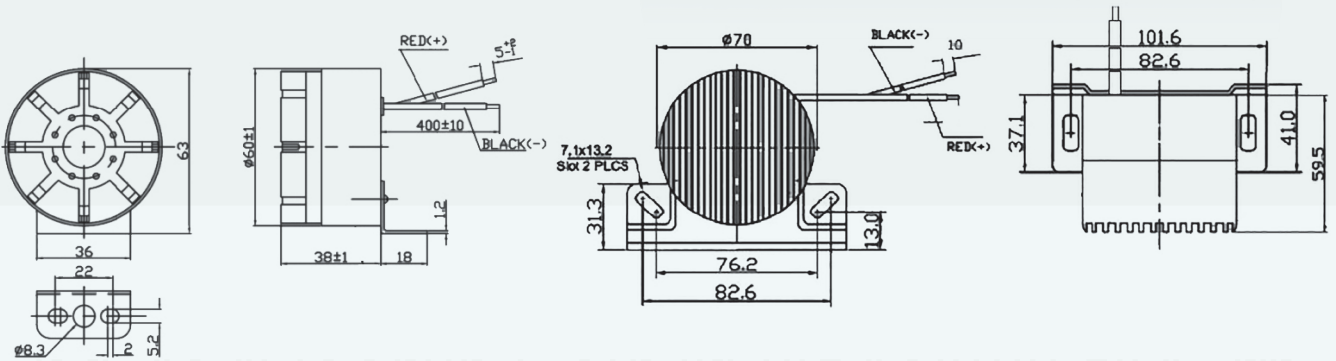
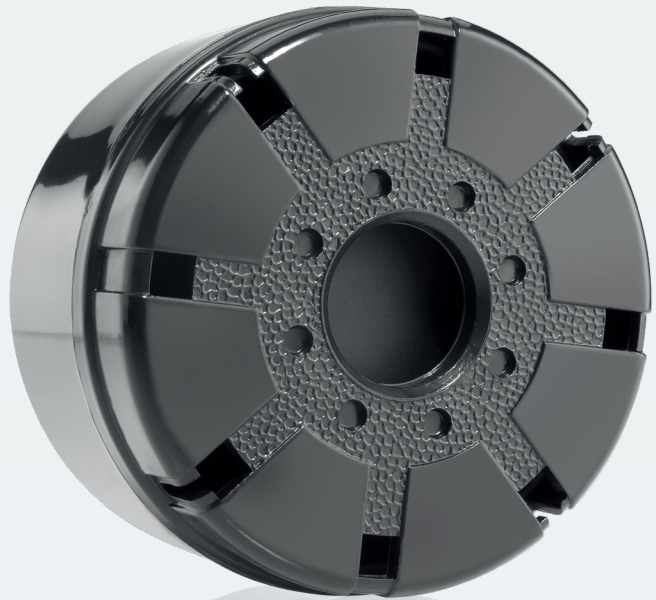

OUR RECOMMENDATION	Design Options					VEHICLE APPLICATION	
	Fixed sound pressure	Black	3.5V – 30V	Single piece High pulse tone	0 986 334 001		
	Self adjusting sound pressure	Black	9 – 28V	Single piece High pulse tone	0 986 334 002		

For more options and available part numbers, please refer to Appendix

Application Summary



OUR RECOMMENDATION	Europa	Design Options						VEHICLE APPLICATION		
		Decorative Ring	Black	12V	Set; 2 horns comprising of 1 high tone & 1 low tone	• 300 Hz / 375 Hz	0 986 AH0 210			
			Silver	12V 24V		• 300 Hz / 375 Hz • 300 Hz / 375 Hz	0 320 223 911 0 986 AH0 211			
	Decorative Grill	Black	12V	Set; 2 horns comprising of 1 high tone & 1 low tone	• 300 Hz / 375 Hz	0 320 223 910				
Chrome		24V 24V	• 300 Hz / 375 Hz • 300 Hz / 375 Hz		0 986 AH0 213 0 986 AH0 212					

OUR RECOMMENDATION	Piccolo						VEHICLE APPLICATION	
		Black	16V	Single Horn	• 420 Hz	0 986 AH0 713		
12V			• 420 Hz		0 986 AH0 712			











OUR RECOMMENDATION	Megatone						VEHICLE APPLICATION		
		Silver	12V	Set; 2 horns comprising of 1 high tone & 1 low tone	• 325 Hz / 400 Hz	0 986 AH0 203			











OUR RECOMMENDATION	FC2 Disc Compact						VEHICLE APPLICATION	
		Black	12V	Set; 2 horns comprising of 1 high tone & 1 low tone	• 350 Hz / 420 Hz	0 986 AH0 103		

OUR RECOMMENDATION	Motorcycle Mini						VEHICLE APPLICATION	
		Black	6V	Single Horn	• 430 Hz	0 986 AH0 002		
12V			• 430 Hz		0 986 AH0 003			

OUR RECOMMENDATION	FC4 Disc Standard	Design Options						VEHICLE APPLICATION		
		Standard (Single Point Mounting)	Steel	6V 12V	(6V) Single Horn (12V) Set; 2 horns comprising of 1 high tone & 1 low tone	• 335 Hz	0 986 320 101			
			Black	6V 12V		• 335 Hz / 420 Hz	0 986 320 191			
		3-Point Mounting	Black	12V	Single horn with 3-point type connection for mounting	• 335 Hz / 420 Hz	0 986 AH0 192			
• 335 Hz	0 986 320 110									











OUR RECOMMENDATION	FD4 Disc Duty	Design Options						VEHICLE APPLICATION		
		Standard	Steel +Grey	12V 24V	Set; 2 horns comprising of 1 high tone & 1 low tone	• 335 Hz / 420 Hz	0 986 320 392			
			Black	24V		• 335 Hz / 420 Hz	0 986 320 394			
Decorative Grill	Steel + Black Grill	12V	Set; 2 horns comprising of 1 high tone & 1 low tone	• 335 Hz / 420 Hz	0 986 AH0 193					









OUR RECOMMENDATION	H3F Digital Fanfare						VEHICLE APPLICATION	 
		Black	12V	Set; 2 horns comprising of 1 high tone & 1 low tone	• 420 Hz / 500 Hz	0 986 AH0 601		 













OUR RECOMMENDATION	EC9C Fanfare Wafer						VEHICLE APPLICATION	 	
			Chrome	12V	Set; 2 horns comprising of 1 high tone & 1 low tone	• 420 Hz / 510 Hz		6 033 FB1 510	 
		Black	12V	• 420 Hz / 510 Hz		9 320 335 206			











OUR RECOMMENDATION	Evolution Fanfare Horn						VEHICLE APPLICATION	 	
			Orange	12V	Single (Low Tone)	• 410 Hz		0 986 AH0 457	 
		Single (High Tone)			• 510 Hz	0 986 AH0 458			
		Set (Low & High Tone)			• 410 Hz / 510 Hz	0 986 AH0 459			













OUR RECOMMENDATION	Strider Fanfare Horn						VEHICLE APPLICATION	 	
			Grey	12V	Single (Low Tone)	• 400 Hz		0 986 AH0 218	 
		Single (High Tone)			• 500 Hz	0 986 AH0 219			
		Set (Low & High Tone)			• 400 Hz / 500 Hz	0 986 AH0 220			

OUR RECOMMENDATION	Windtone						VEHICLE APPLICATION	 	
			Red	12V	Set; 2 horns comprising of 1 high tone & 1 low tone	• 420 Hz / 500 Hz		0 986 AH0 507	 
		Black	12V	• 420 Hz / 500 Hz		0 986 AH0 503			

OUR RECOMMENDATION	Trucker						VEHICLE APPLICATION	  
			Chrome	5 - 8 bar	Single horn with 2 trumpets of varying tones	• 300 Hz / 320 Hz		0 328 100 002

OUR RECOMMENDATION	2-3 Tone Air Fanfare						VEHICLE APPLICATION	     	
			Mini 2-tone	Red	12V	2 trumpets with varying tones, and a compressor unit		• 735 Hz / 785 Hz	0 986 320 003
		2-tone	Red	12V 24V	• 630 Hz / 795 Hz			0 328 003 024	
		3-tone	Red	12V	3 trumpets with varying tones, and a compressor unit	• 630 Hz / 795 Hz / 840 Hz		0 328 003 025	

OUR RECOMMENDATION	Fanfare Windtone 24V						VEHICLE APPLICATION    
		Black	24V	Sets of 2 horns, 1 High tone, 1 Low tone	• 410 Hz / 510 Hz	0 986 AH0 454	

OUR RECOMMENDATION	Fanfare Air Master						VEHICLE APPLICATION      						
									Black with Red	12V	Single horn with 2 trumpet of high and low tone	• 520 Hz/ 660 Hz	0 986 320 400
										24V		• 520 Hz/ 660 Hz	0 986 320 401

Europa Supertone

Design Option	Colour	Voltage	Unit Quantity	Unit Description	Frequency	Part Number
Decorative Grill	Black	12V	Single	Low tone horn	300 Hz	0 320 223 804
	Black	12V	Single	High tone horn	375 Hz	0 320 223 805
	Black	12V	Set	Comprising of 0 320 223 804 and 0 320 223 805	300 Hz/ 375 Hz	0 320 223 910
	Chrome	12V	Single	Low tone horn	300 Hz	0 320 223 144
	Chrome	12V	Single	High tone horn	375 Hz	0 320 223 145
	Chrome	12V	Set	Comprising of 0 320 223 144 and 0 320 223 145	300 Hz/ 375 Hz	0 986 AH0 212
	Black	24V	Single	Low tone horn	300 Hz	0 320 226 004
	Black	24V	Single	High tone horn	375 Hz	0 320 226 005
	Black	24V	Set	Comprising of 0 320 226 004 and 0 320 226 005	300 Hz/ 375 Hz	0 986 AH0 213
Decorative Plastic Grill	Black	12V	Single	Low tone horn	300 Hz	0 320 223 024
	Black	12V	Single	High tone horn	375 Hz	0 320 223 025
Decorative Ring	Black	12V	Single	Low tone horn	300 Hz	0 320 223 027
	Black	12V	Single	High tone horn	375 Hz	0 320 223 028
	Black	12V	Set	Comprising of 0 320 223 027 and 0 320 223 028	300 Hz/ 375 Hz	0 986 AH0 210
	Silver	12V	Single	Low tone horn	300 Hz	0 320 223 016
	Silver	12V	Single	High tone horn	375 Hz	0 320 223 017
	Silver	12V	Set	Comprising of 0 320 223 016 and 0 320 223 017	300 Hz/ 375 Hz	0 320 223 911
	Silver	24V	Single	Low tone horn	300 Hz	0 320 226 016
	Silver	24V	Single	High tone horn	375 Hz	0 320 223 017
	Silver	24V	Set	Comprising of 0 320 226 016 and 0 320 226 017	300 Hz/ 375 Hz	0 986 AH0 211
*Decorative Ring <i>(for priority vehicles e.g. police, ambulance, fire engines, etc.)</i>	Silver	12V	Single	Low tone horn for special priority vehicles	375 Hz	0 320 223 008
	Silver	12V	Single	High tone horn for special priority vehicles	500 Hz	0 320 223 009
	Black	12V	Single	Low tone horn for special priority vehicles	375 Hz	0 320 223 002
	Black	12V	Single	High tone horn for special priority vehicles	500 Hz	0 320 223 003
	Black	24V	Single	Low tone horn for special priority vehicles	375 Hz	0 320 226 002
	Black	24V	Single	High tone horn for special priority vehicles	500 Hz	0 320 226 003

Europa Supertone

Design Option	Colour	Voltage	Unit Quantity	Unit Description	Frequency	Part Number
Standard	Black/ Silver	12V	Single	Low tone horn	300 Hz	0 320 223 021
	Black/ Silver	12V	Single	High tone horn	375 Hz	0 320 223 022
	Black	12V	Single	Connection Type B*	375 Hz	0 320 223 011
	Black	12V	Single	Connection Type B**	500 Hz	0 320 223 012
	Black/ Silver	24V	Single	Low tone	300 Hz	0 320 226 007
	Black/ Silver	24V	Single	Medium-high tone*	375 Hz	0 320 226 008
	Black/ Silver	24V	Single	High tone*	500 Hz	0 320 226 009
	Black	24V	Single	Medium-high tone*	375 Hz	0 320 226 010
	Black	24V	Single	Connection Type B**	375 Hz	0 320 226 011
	Black	24V	Single	Connection Type B**	500 Hz	0 320 226 012

*Applicable for special priority vehicles such as police vehicles, fire-engines, ambulances etc

**With connection Type B; All other part numbers, unless indicated otherwise, belong to Type A

Connection Types for Europa Supertone

Connection Type A

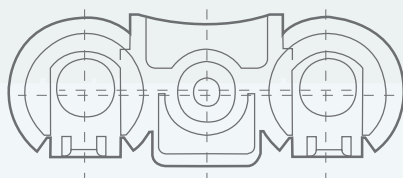

Connection Type B

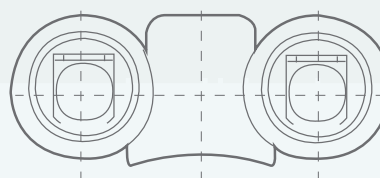

FC2 Disc Compact

Design Option	Colour	Voltage	Unit Quantity	Unit Description	Frequency	Part Number
	Black	12V	Single	Low tone horn	350 Hz	0 986 AH0 101
	Black	12V	Single	High tone horn	420 Hz	0 986 AH0 102
	Black	12V	Set	Comprising of 0 986 AH0 101 and 0 986 AH0 102	350 Hz/ 420 Hz	0 986 AH0 103

FC9

Design Option	Colour	Voltage	Unit Quantity	Unit Description	Frequency	Part Number
	Steel	12V	Single	Low tone horn	335 Hz	9 320 332 803
	Steel	12V	Single	High tone horn	420 Hz	9 320 332 804
	Steel	12V	Set	Comprising of 9 320 332 803 and 9 320 332 804	335 Hz/ 420 Hz	9 320 332 802
	Steel	24V	Single	Low tone horn	335 Hz	6 033 FB4 102
	Steel	24V	Single	High tone horn	420 Hz	6 033 FB4 103
	Steel	24V	Set	Comprising of 6 033 FB4 102 and 6 033 FB4 103	335 Hz/ 420 Hz	6 033 FB4 147

FC4 Disc Standard

Design	Colour	Voltage	Unit	*Mounting Plate Thickness (a mm)	*Mounting Hole Diameter (Øb mm)	*Mounting Angle (α°)	Unit Description	Frequency	Part Number
Standard	Steel	6V	Single	2.4 mm	Thread M8	275°	Type A Connection**	335 Hz	0 986 320 101
	Black	6V	Single	1.6 mm	8.4 mm	175°	Type A Connection**	335 Hz	0 986 320 102
	Steel	12V	Single	2.4 mm	Thread M8	90°	Type A Connection**	335 Hz	0 986 320 111
	Steel	12V	Single	1.6 mm	8.4 mm	60°	Type A Connection**	335 Hz	0 986 320 132
	Steel	12V	Single	1.6 mm	8.4 mm	300°	Type A Connection**	420 Hz	0 986 320 133
	Steel	12V	Set	1.6 mm	8.4 mm	-	0 986 320 132 and 0 986 320 133	335 Hz/ 420 Hz	0 986 320 191
	Steel	12V	Single	1.6 mm	8.4 mm	275°	Type A Connection**	335 Hz	0 986 320 146
	Steel	12V	Single	1.6 mm	10.5 mm	90°	Type A Connection**	335 Hz	0 986 320 112
	Steel	12V	Single	1.6 mm	8.4 mm	90°	Type A Connection**	420 Hz	0 986 320 147
	Steel	12V	Single	2.4 mm	8.7 mm	100°	Type A Connection**	420 Hz	0 986 320 140
	Black	12V	Single	1.6 mm	8.4 mm	60°	Type A Connection**	335 Hz	0 986 320 137
	Black	12V	Single	2.4 mm	8.4 mm	100°	Type A Connection**	335 Hz	0 986 320 188
	Black	12V	Single	2.4 mm	8.4 mm	300°	Type A Connection**	335 Hz	0 986 320 131
	Black	12V	Single	1.6 mm	8.4 mm	285°	Type B Connection**	335 Hz	0 986 320 148
	Black	12V	Single	1.6 mm	8.4 mm	180°	Type A Connection**	335 Hz	0 986 320 113
	Black	12V	Single	1.6 mm	8.4 mm	300°	Type A Connection**	335 Hz	0 986 320 136
	Black	12V	Single	2.0 mm	8.4 mm	60°	Type C Connection**	335 Hz	0 986 320 110
	Black	12V	Single	1.6 mm	8.4 mm	270°	Type A Connection**	420 Hz	0 986 320 114
	Black	12V	Set	1.6 mm	8.4 mm	-	0 986 320 137 and 0 986 320 114	335 Hz/ 420 Hz	0 986 AH0 192
	Black	12V	Single	1.6 mm	8.4 mm	285°	Type B Connection**	420 Hz	0 986 320 149

*Refer to technical drawing and dimensions on FC4 Disc Standard product page

**Refer to Connection Type drawing for FC4 and FD4 horns on page 31

FD4 Disc Duty

Design	Colour	Voltage	Unit	*Mounting Plate Thickness (a mm)	*Mounting Hole Diameter (Øb mm)	*Mounting Angle (α°)	Unit Description	Frequency	Part Number
Standard	Steel	12V	Single	1.6 mm	8.4 mm	60°	Type A Connection**	335 Hz	0 986 320 310
	Steel	12V	Single	1.6 mm	8.4 mm	300°	Type A Connection**	420 Hz	0 986 320 311
	Steel	12V	Set	1.6 mm	8.4 mm	-	Comprising of 0 986 320 310 and 0 986 320 311	335 Hz/420 Hz	0 986 320 392
	Steel	24V	Single	1.6 mm	8.4 mm	270°	Type A Connection**	335 Hz	0 986 320 301
	Steel	24V	Single	1.6 mm	8.4 mm	60°	Type A Connection**	420 Hz	0 986 320 302
	Steel	24V	Set	1.6 mm	8.4 mm	-	Comprising of 0 986 320 301 and 0 986 320 302	335 Hz/420 Hz	0 986 320 394
	Black	24V	Single	1.6 mm	8.4 mm	270°	Type A Connection**	335 Hz	0 986 320 317
	Black	24V	Single	2.4 mm	8.4 mm	90°	Type A Connection**	335 Hz	0 986 320 314
	Black	24V	Single	2.4 mm	10.5 mm	155°	Type B Connection**	335 Hz	0 986 320 312
	Black	24V	Single	2.4 mm	8.4 mm	270°	Type A Connection**	335 Hz	0 986 320 351
	Black	24V	Single	2.4 mm	8.4 mm	60°	Type A Connection**	420 Hz	0 986 320 316
	Black	24V	Set	2.4 mm	8.4 mm	-	Comprising of 0 986 320 351 and 0 986 320 316	335 Hz/420 Hz	0 986 AH0 193
	Black	24V	Single	2.4 mm	8.4 mm	155°	Type B Connection**	420 Hz	0 986 320 313
	Decorative Grill	Steel/Black	12V	Single	1.6 mm	8.4 mm	60°	Type A Connection**	335 Hz
Steel/Black		12V	Single	1.6 mm	8.4 mm	60°	Type A Connection**	420 Hz	0 986 320 307
Steel/Black		12V	Set	1.6 mm	8.4 mm	-	Comprising of 0 986 320 351 and 0 986 320 316	335 Hz/420 Hz	0 986 320 393

*Refer to technical drawing and dimensions on FD4 Disc Duty product page
 **Refer to Connection Type drawing for FC4 and FD4 horns below

Connection Types for FC4 and FD4 horns

Type A



Type B

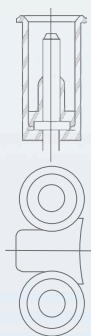

Type C

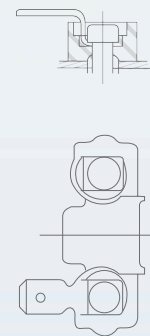

Megatone

Design Option	Colour	Voltage	Unit Quantity	Unit Description	Frequency	Part Number
	Silver	12V	Single	Low tone horn	325 Hz	0 986 AH0 201
	Silver	12V	Single	High tone horn	400 Hz	0 986 AH0 202
	Silver	12V	Set	Comprising of 0 986 AH0 201 and 0 986 AH0 202	325 Hz/ 400 Hz	0 986 AH0 203

Motorcycle Mini

Design Option	Colour	Voltage	Unit Quantity	Unit Description	Frequency	Part Number
	Black	6V	Single	Single horn	430 Hz	0 986 AH0 002
	Black	12V	Single	Single horn	430 Hz	0 986 AH0 003

Piccolo

Design Option	Colour	Voltage	Unit Quantity	Unit Description	Frequency	Part Number
	Black	6V	Single	Single horn	420 Hz	0 986 AH0 713
	Black	12V	Single	Single horn	420 Hz	0 986 AH0 712

Evolution Fanfare Horn

Design Option	Colour	Voltage	Unit Quantity	Unit Description	Frequency	Part Number
	Orange	12V	Single	Low tone horn	410 Hz	0 986 AH0 457
	Orange	12V	Single	High tone horn	510 Hz	0 986 AH0 458
	Orange	12V	Set	Low & High tone horn	410 Hz/ 510 Hz	0 986 AH0 459

Strider Fanfare Horn

Design Option	Colour	Voltage	Unit Quantity	Unit Description	Frequency	Part Number
	Grey	12V	Single	Low tone horn	400 Hz	0 986 AH0 218
	Grey	12V	Single	High tone horn	500 Hz	0 986 AH0 219
	Grey	12V	Set	Low & High tone horn	400 Hz/ 500 Hz	0 986 AH0 220

EC9

Design Option	Colour	Voltage	Unit Quantity	Unit Description	Frequency	Part Number
*Painted Housing	Black	12V	Single	Low tone horn	420 Hz	6 033 FB1 213
	Black	12V	Single	High tone horn	510 Hz	6 033 FB1 214
	Black	12V	Set	Comprising of 6 033 FB1 213 and 6 033 FB1 214	420 Hz/ 510 Hz	6 033 FB1 217
*Galvanised Housing	Black	12V	Single	Low tone horn	420 Hz	6 033 FB2 011
	Black	12V	Single	High tone horn	510 Hz	6 033 FB2 012
	Black	12V	Set	Comprising of 6 033 FB2 011 and 6 033 FB2 012	420 Hz/ 510 Hz	9 320 335 007
	Red	12V	Single	Low tone horn	420 Hz	9 320 335 111
	Red	12V	Single	High tone horn	510 Hz	9 320 335 112
	Red	12V	Set	Comprising of 9 320 335 112 and 9 320 335 113	420 Hz/ 510 Hz	9 320 335 113
	Chrome	12V	Single	Low tone horn	420 Hz	6 033 FB1 194
	Chrome	12V	Single	High tone horn	510 Hz	6 033 FB1 195
	Chrome	12V	Set	Comprising of 6 033 FB1 194 and 6 033 FB1 195	420 Hz/ 510 Hz	6 033 FB1 193
	Black	-	Set	Comprising of relays, small parts and mounting instructions	-	9 320 335 052

EC9C Fanfare Wafer

Design Option	Colour	Voltage	Unit Quantity	Unit Description	Frequency	Part Number
	Black	12V	Single	Low tone horn	420 Hz	9 320 335 207
	Black	12V	Single	High tone horn	510 Hz	9 320 335 208
	Black	12V	Set	Comprising of 9 320 335 207 and 9 320 335 208	420 Hz/ 510 Hz	9 320 335 206
	Chrome	12V	Single	Low tone horn	420 Hz	6 033 FB1 505
	Chrome	12V	Single	High tone horn	510 Hz	6 033 FB1 506
	Chrome	12V	Set	Comprising of 6 033 FB1 505 and 6 033 FB1 506	420 Hz/ 510 Hz	6 033 FB1 510

H3F Digital Fanfare

Design Option	Colour	Voltage	Unit Quantity	Unit Description	Frequency	Part Number
	Black	12V	Single	Low tone horn	400 Hz	0 986 AH0 761
	Black	12V	Single	High tone horn	500 Hz	0 986 AH0 762
	Black	12V	Set	Comprising of 0 986 AH0 761 and 0 986 AH0 762	400 Hz/ 500 Hz	0 986 AH0 601

Windtone

Design Option	Colour	Voltage	Unit Quantity	Unit Description	Frequency	Part Number
	Black	12V	Single	Low tone horn	420 Hz	0 986 AH0 501
	Black	12V	Single	High tone horn	500 Hz	0 986 AH0 502
	Black	12V	Set	Comprising of 0 986 AH0 761 and 0 986 AH0 762	420 Hz/ 500 Hz	0 986 AH0 503
	Red	12V	Single	Low tone horn	420 Hz	0 986 AH0 505
	Red	12V	Single	High tone horn	500 Hz	0 986 AH0 506
	Red	12V	Set	Comprising of 0 986 AH0 761 and 0 986 AH0 762	420 Hz/ 500 Hz	0 986 AH0 507

Windtone 24V

Design Option	Colour	Voltage	Unit Quantity	Unit Description	Frequency	Part Number
	Black	24V	Single	Low Tone	410 Hz	0 986 AH0 456
	Black	24V	Single	High Tone	510 Hz	0 986 AH0 455
	Black	24V	Set	Comprising of 0 986 AH0 455 and 0 986 AH0 456	410 Hz/ 510 Hz	0 986 AH0 454

Air Master

Design Option	Colour	Voltage	Unit Quantity	Unit Description	Frequency	Part Number
	Black with Red	12V	Single	Single horn with 2 trumpet of high and low tone	520 Hz/ 660 Hz	0 986 320 400
	Black with Red	24V	Single	Single horn with 2 trumpet of high and low tone	520 Hz/ 660 Hz	0 986 320 401

Appendix

Compressor Trumpets

Trucker

Design Option	Colour	Voltage	Unit Quantity	Unit Description	Frequency	Part Number
	Chrome	-	Single	Low tone horn	300 Hz/ 320 Hz	0 328 100 002

2-3 Tone Air Fanfare

Design Option	Colour	Voltage	Unit Quantity	Unit Description	Frequency	Part Number
Mini 2-tone	Red	12V	Single	2 trumpets with varying tones and a compressor unit	795 Hz/ 840 Hz	0 986 320 003
2-tone	Red	12V	Single	2 trumpets with varying tones and a compressor unit	630 Hz/ 795 Hz	0 328 003 024
	Red	24V	Single	2 trumpets with varying tones and a compressor unit	630 Hz/ 795 Hz	0 328 006 002
3-tone	Red	12V	Single	2 trumpets with varying tones and a compressor unit	630 Hz/ 795 Hz/ 840 Hz	0 328 003 025

Appendix

Backup Buzzer

Backup Buzzer

Design Option	Colour	Voltage	Unit Quantity	Unit Description	Part Number
Fixed sound pressure	Black	24V	Single	High pulse tone	0 986 334 001
Self adjusting sound pressure	Black	24V	Single	High pulse tone	0 986 334 002



Robert Bosch Sdn. Bhd.
8A, Jalan 13/6,
46200 Petaling Jaya, Selangor.
Tel: (6) 03 7966 3003

🌐 www.bosch.com.my
📍 **Bosch Autoparts Malaysia**

Authorised Dealer